

## 455nm 光纤耦合半导体激光器

**Model: JL-FC-455-30W-200-0.22NA**

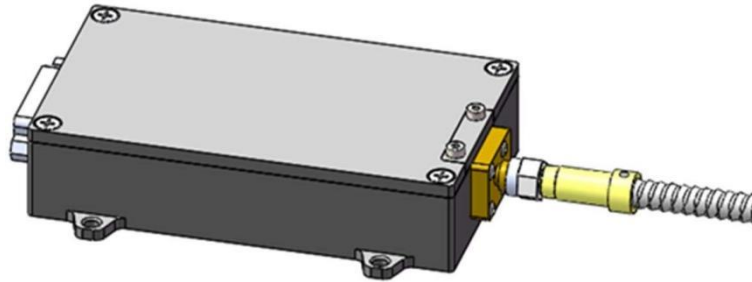

### ■ Features/主要特性

- Center Wavelength 455nm
- Output Power 30W
- Fiber Core Diameter 200 $\mu$ m
- Fiber Number Aperture 0.22

### ■ Applications/应用领域

- Medica 医疗
- Welding 焊接

### ■ Remark/备注

- 模块接受定制，如光纤芯径、功率、尺寸、光纤线长、接头规格等。
- Module accepts customization, such as fiber core diameter, power, size, fiber cable length, connector specification and so on.



性能参数 (25°C) Performance Parameters	符号 Symbol	单位 Unit	典型值 Type
<b>光学参数 Optical Parameters</b>			
中心波长 Center Wavelength	$\lambda_c$	nm	455±10
输出功率 Output Power	$P_o$	W	30
光谱宽度 (FWHM/Spectral Width)	$\Delta\lambda$	nm	<10
<b>电学参数 Electrical Parameters</b>			
光电转换效率 Power Conversion Efficiency	PE	%	>30
阈值电流 Threshold Current	$I_{th}$	A	<0.4
工作电流 Operating Current	$I_{op}$	A	<3
工作电压 Operating Voltage	$V_{op}$	V	<41
<b>光纤参数 Fiber Parameters</b>			
光纤芯径 Fiber Core Diameter	$D_{core}$	μm	200
光纤接头 Fiber Connector	-	-	SMA905
光纤长度 Fiber Length	$L_f$	m	1.0
<b>其他参数 Others Parameters</b>			
存储温度 Storage Temperature	$T_{st}$	°C	-20 ~ +70
焊接温度 Welding Temperature	$T_{ls}$	°C	260
焊接时间 Welding Time	t	sec	10
工作温度 Operating Temperature	$T_{op}$	°C	25±10
相对湿度 Relative Humidity	RH	%	<75
水冷温度 Cooling Temperature	-	°C	18-28

外形尺寸:

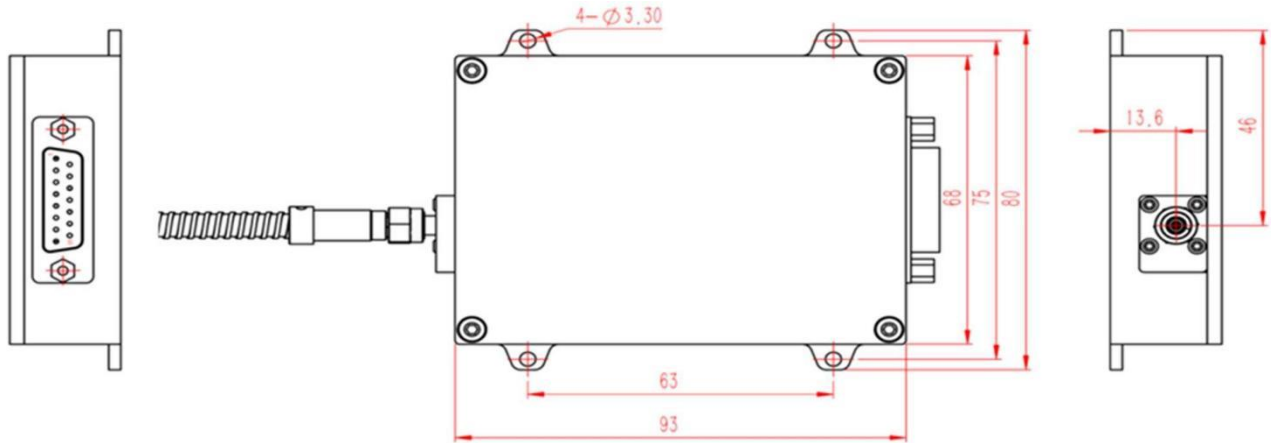

管脚定义/Pin-Out Assignment			
Pin	Function	Pin	Function
1	-	8	Thermistor(-)
2	-	9	PD(+)
3	LD(-)	10	PD(-)
4	LD(+)	11	Fiber Connector Detector
5	Aiming laser(+)	12	Fiber Connector Detector LED (-)
6	Aiming laser(-)	13	Fiber Connector Detector LED (+)
7	Thermistor(+)		

## Operating Notes 使用说明

□运输及存储时必须采取防静电措施。

Esd measures must be taken during transportation and storage.

□激光器工作时，避免激光照射眼睛和皮肤。

Avoid eyes and skin exposure to direct radiation during operation.

□使用恒流电源，工作时避免浪涌。

Use constant current power supply to avoid surge during operation.

□激光器工作时，应在额定电流、额定功率条件下使用。

Diode laser must be used according to specifications and the maximum optical power should not be exceeded.

□激光器工作时，需保证散热良好。

Diode laser must be operated under good cooling condition.

\*以上产品外观及尺寸数据仅供参考，以用户实际订购数据为准。

We can customized the laser according to customer need.

